

- **TRIUMF** survey of muon beams
- **Comparison** of muon rates in various beamlines
- **Mega beam line** at LAMPF (now called LANCE)

This beamline has been decommissioned and may be available. Contactperson: Martin Cooper, 505-667-2929, mcooper@lanl.gov

Three pages from the LAMPF Users Handbook.

This beam was designed by Pat Thompson, now at BNL/RHIC, 516-344-7635.

Sec, P.A. Thompson et al, 'The Stopped Muon Channel at LAMPF', NIM 161 (1979) 391-411.

- **BNL D Line**

The "Gif image" includes the D2 muon channel

- **Muon beam lines at the Paul Scherrer Institute**

1. μ E1 beam line

2. μ E4 beam line

- **TRIUMF M-20 beam line**
- **The M-arena of the Japan Hadron Project at KEK**
- **The RIKEN-RAL Muon Facility**

Photograph and key.

Kirk T. McDonald
mcdonald@puphep.princeton.edu
Tel: +1-609-258-6608
Fax: +1-609-258-6360

Muons/200 ns at 60 MeV/c

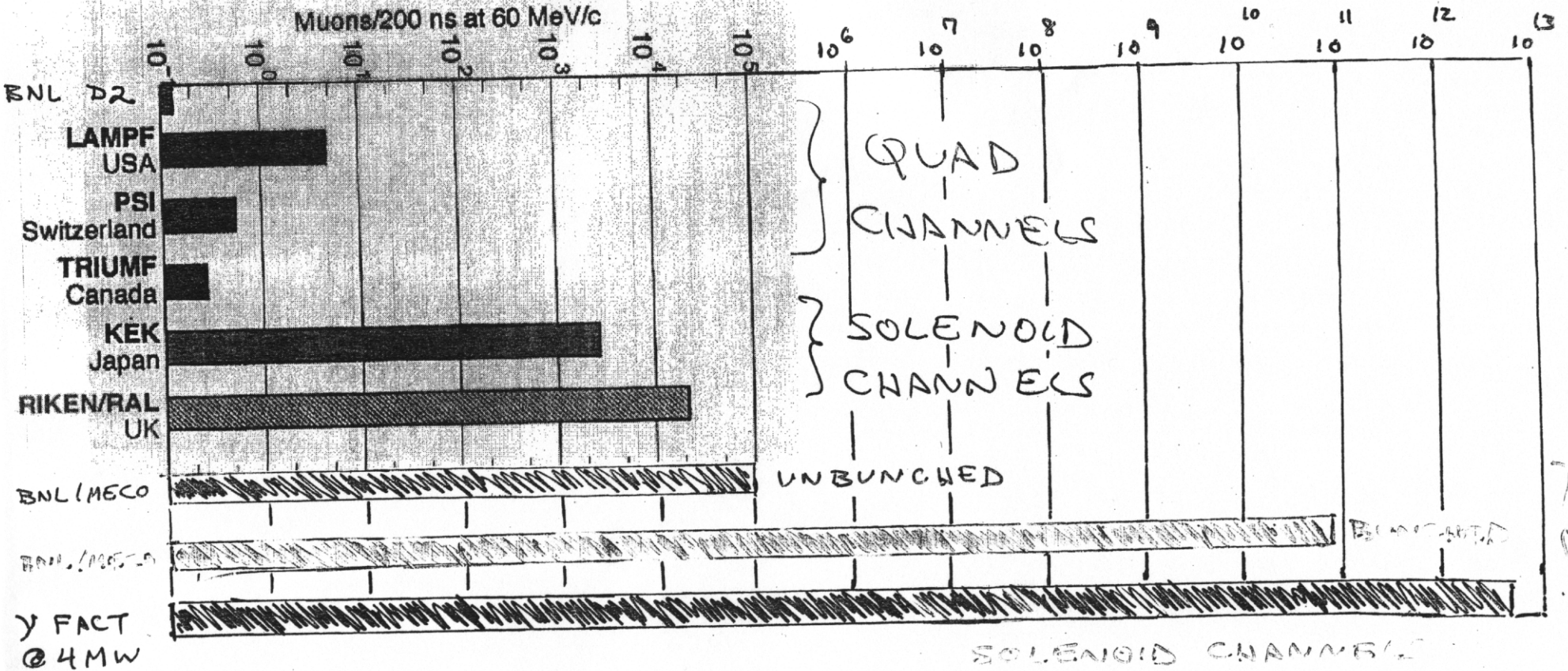

SOLENOID CHANNELS WITH MAGNETIC BOTTLE CAPTURE

Page 2

Muon beam page | back one slide | forward one slide

- 01 02 03 04 05 06 07 08 09 10 11 12 13 14 15 16 17 18 19 20 21 22 23 24 25 26 27 28 29 30
- 31 32 33 34 35 36 37 38 39 40 41 42 43 44 45 46 47 48 49 50 51 52 53 54 55 56 57 58 59 60

SEN BY: Xerox Telecopier 7021 : 4-23-87 : 15:28 : P-25 Group Office- PHYSICS JADWIN HALL: # 3

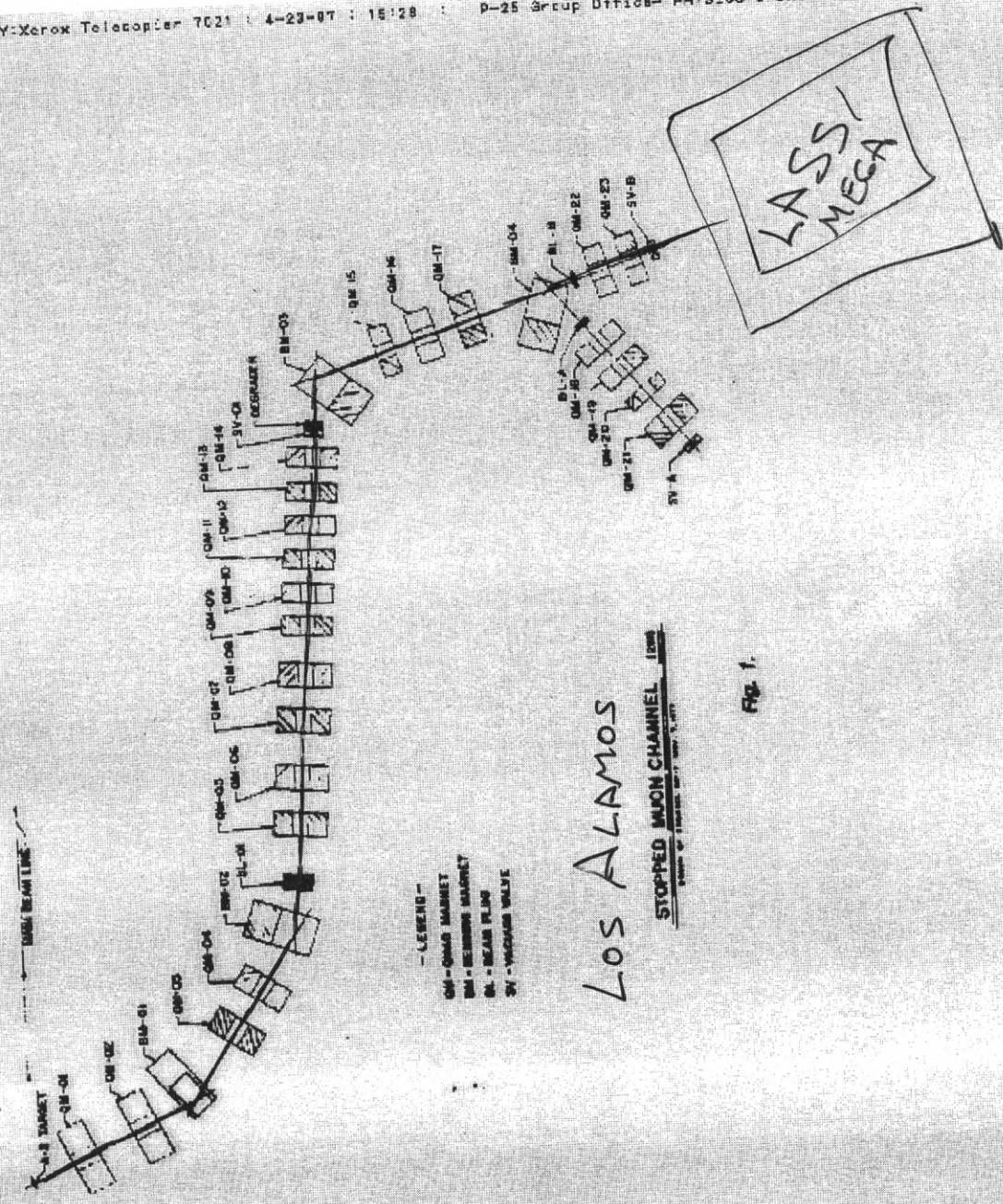

6A-28

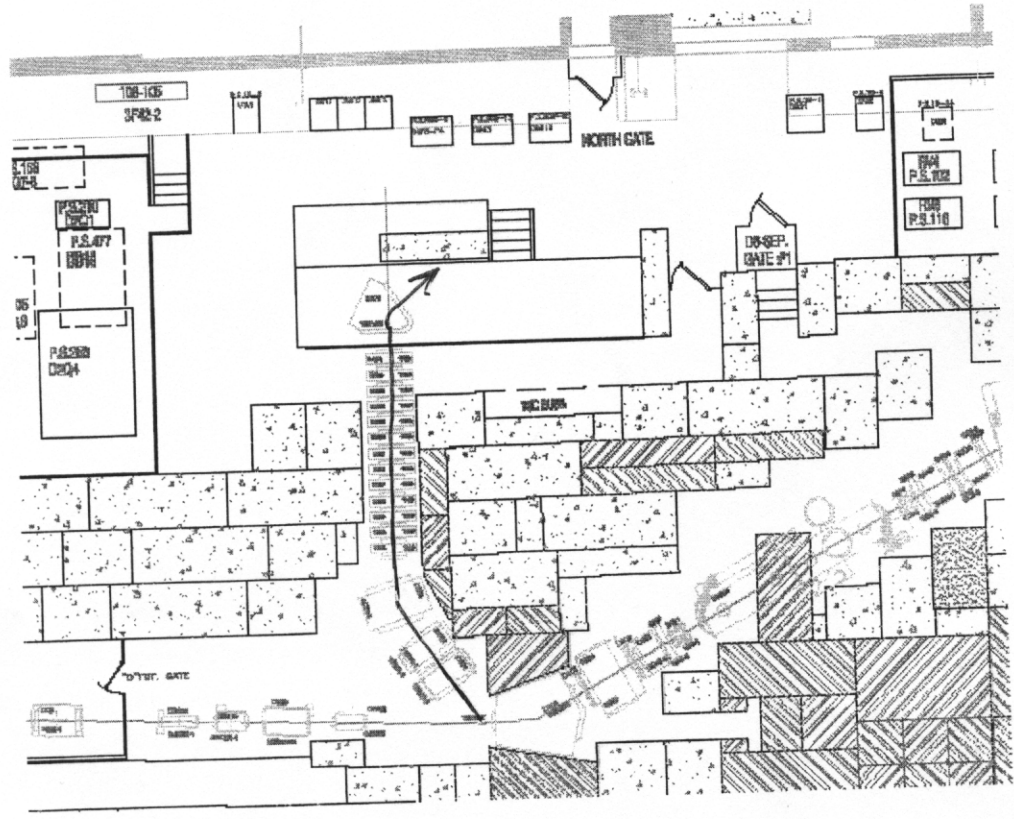

BNL D2 LINE

TRIUMF M20 LINE

IV - 27a

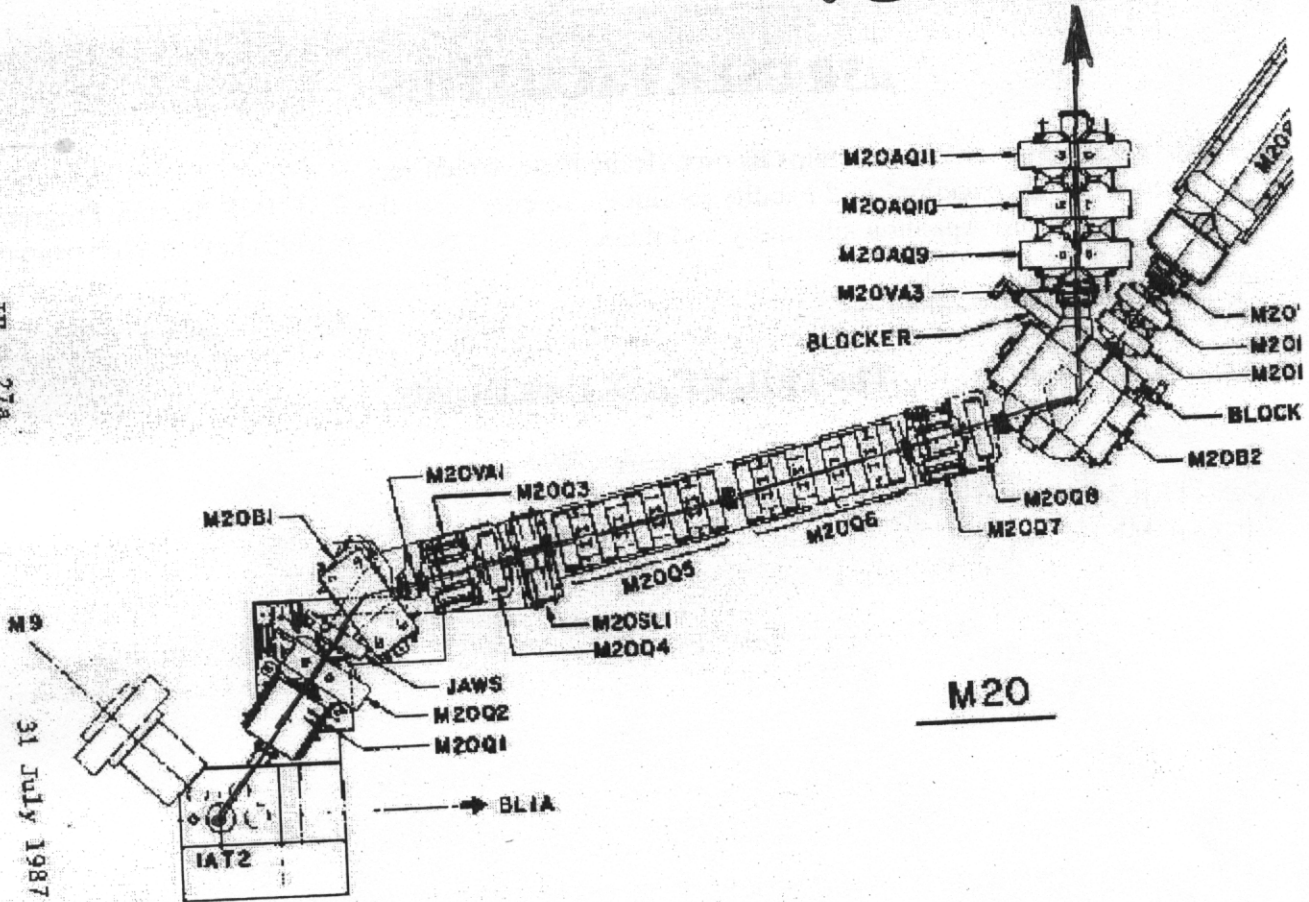

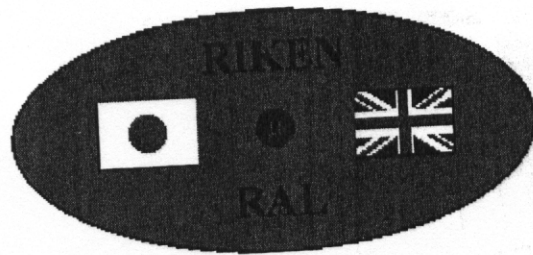

Welcome to the RIKEN-RAL Muon Facility!

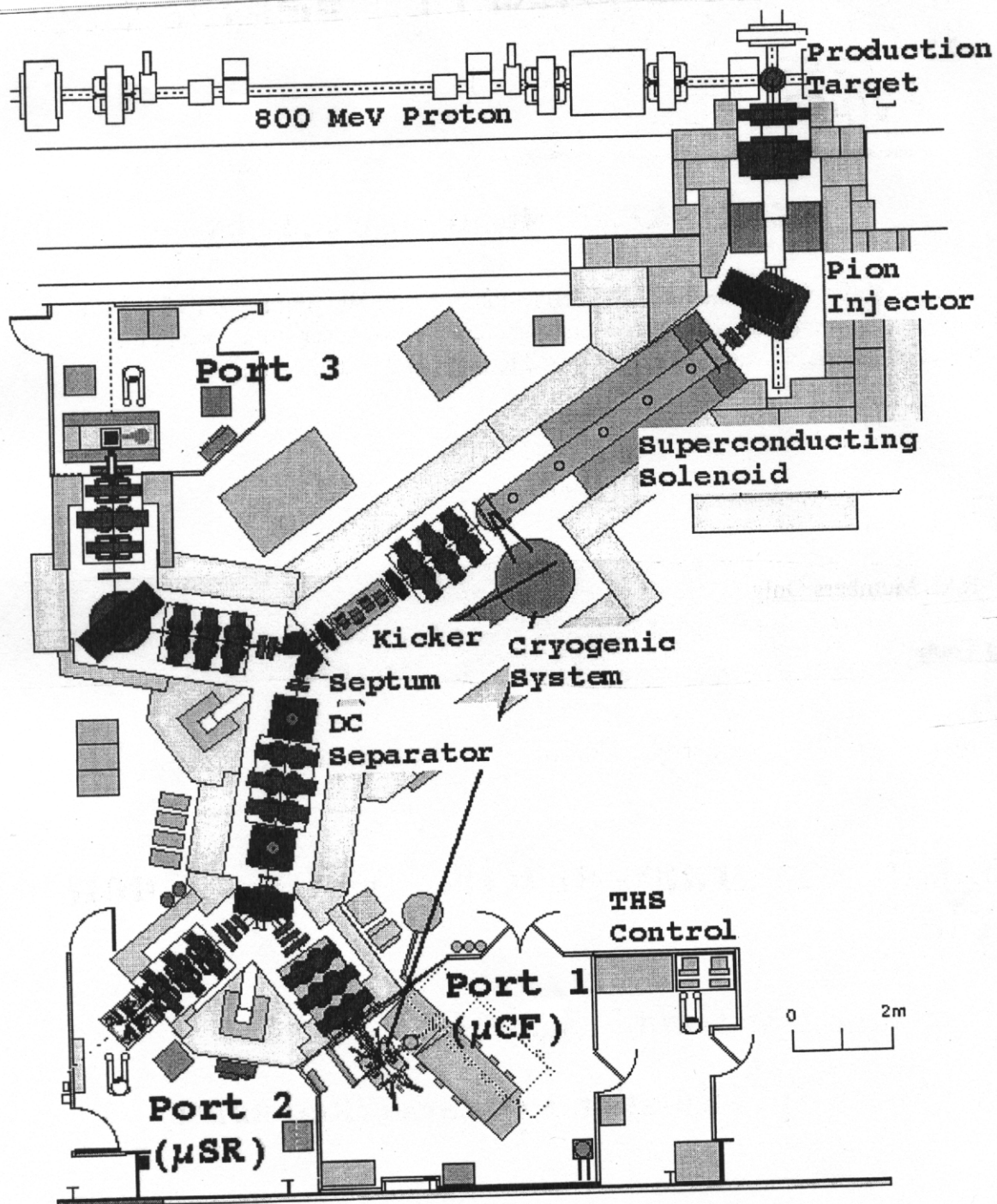

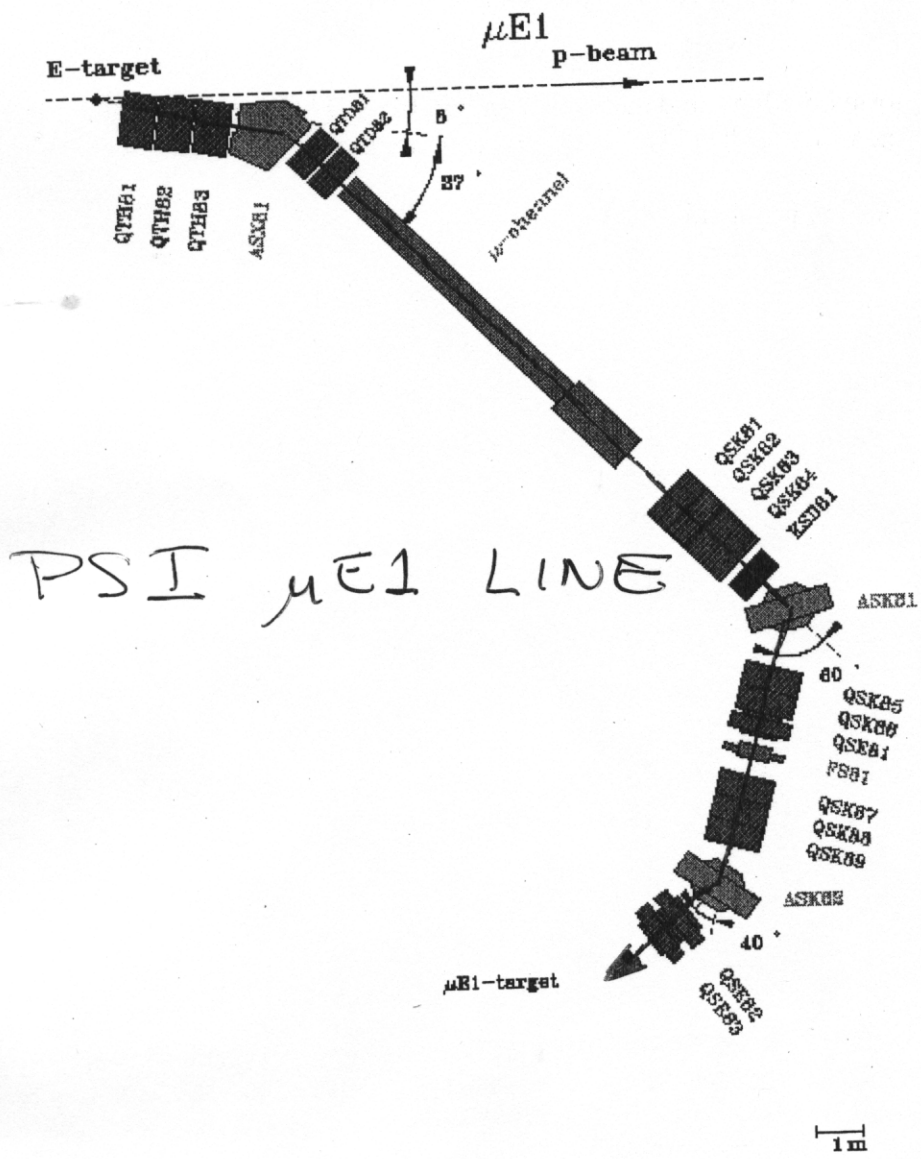

Fig 1 : Magnetic elements in $\mu E1$ beam line

μ E1 beam line

The μ E1 is an experimental area for an intense medium energy polarized muon beam, with very low pion and electron contamination. As in the case of the piE1 beam line, pions from the thick target **TE** are extracted at an angle of 10° in the forward direction using a triplet of half quadrupoles. The beam line consists of three sections

- a pion collection section
- a long superconducting solenoid
- the muon extraction

The main characteristics of the beam line are listed in the following table, and a layout of the experimental area and of the magnetic components are shown in [Fig 1](#) and [Fig 2](#)

Table 1 : Characteristics of the μ E1 beam line

Mode	A		B	
Momentum acceptance (FWHM)	3%		1%	
Pion momentum range [MeV/c]	200	125	220	125
Muon momentum range [MeV/c]	125	85	125	85
Rate of negative muon [$\text{mA}^{-1}\text{s}^{-1}$]	$6e7$	$3e7$	$2e7$	$1e7$
Spot size (FWHM)	horizontal		28 mm	
	vertical		17 mm	

Collection and Decay section

Pions produced at target **TE** are momentum selected by a bending magnet and then focused by a quadrupole doublet onto the entrance of a superconducting solenoid of 8 m length, 12 cm inner free diameter and 5 T field strength. There muons are collected from pions decaying in flight.

The length of the solenoid was chosen in relation to the pion decay length $l(\text{pi})$ [m] = $0.055 \times P(\text{pi})$ [MeV/c].

About half of the pions decay in the solenoid at $P(\text{pi}) = 220$ MeV/c. In this case a broad spectrum of muons is available at the solenoid exit, ranging from 120 to 240 MeV/c.

Extraction Section

The second part of the beam line allows selection of a central muon momentum different from that of the injected pions, preferably at the low momentum edge corresponding to muons decaying backward in the center of mass system. In this case the contamination from electrons originating at the pion production target is very low ($e^+/\mu^+ \sim 5\%$), and the muon beam polarization reaches a high value around 75%. Two different modes of operation are available :

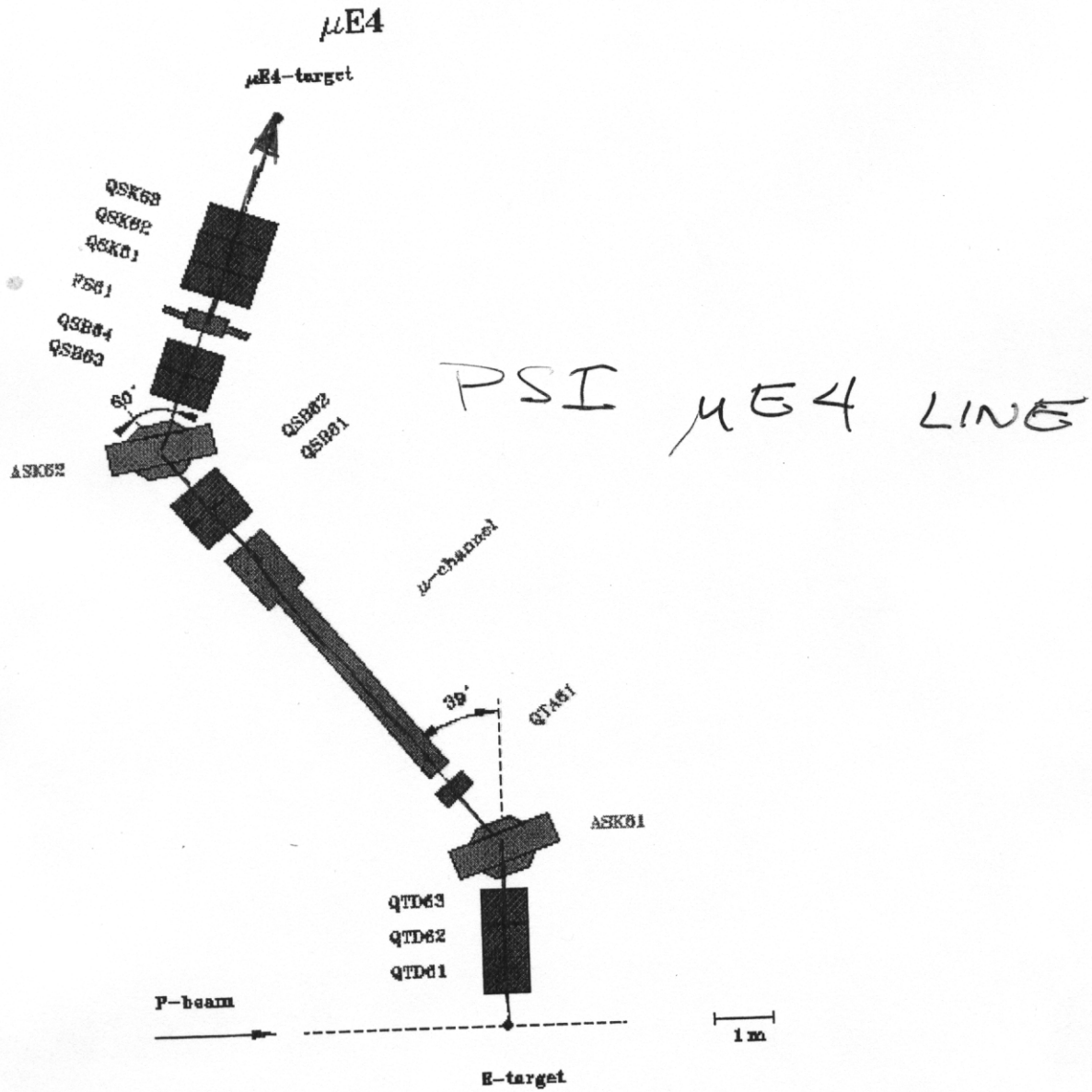

Fig 1 : Magnetic elements in μE4 beam line